

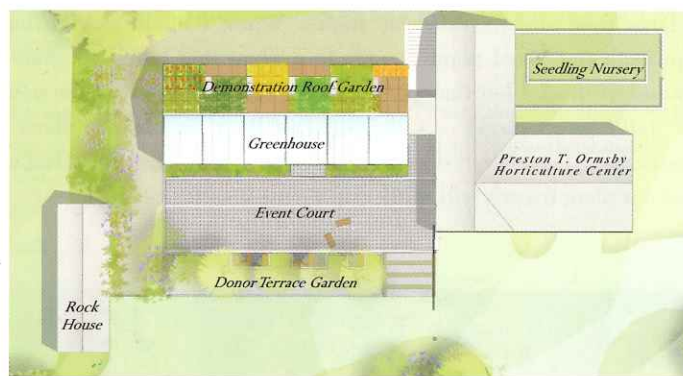

THE CASTLE CHRONICLES

Yew Dell Plans Fall Ground-Breaking For New Horticulture Center



For those of you who have been paying attention, you've known that something big is coming to Yew Dell. The long planned and much anticipated new horticulture facilities will take one step closer to reality with this fall's groundbreaking. Headlining the new facilities will be a super-efficient solar/geothermal greenhouse complete with a green roof, event space and lots of space for rooting cuttings and growing plants. The original Klein Nursery potting shed will be completely upgraded and renovated into the Preston T. Ormsby Horticulture Center Building – the nerve center of all our

garden and plant operations. And in addition to the buildings, there will be new nurseries for ornamental plant research, vegetable variety trials, plant production (think expanded plant sale!) and much more. We're even building new compost facilities, storage for bulk materials and all the other support so desperately needed by our growing horticulture staff. We hope you'll visit often to watch the progress and then plan to come out to the opening planned for spring 2013!

Twilight in the Garden 2012 to Feature Yew Dell's 10th Birthday Celebration!

While we never need a reason to have a party at Yew Dell, this time we have all the reason in the world. This year's Twilight in the Garden will be celebrated in birthday party style to mark Yew Dell's 10th anniversary. The event, sponsored by Brown-Forman, will feature cocktails and food samplings among Yew Dell's incomparable gardens, a limited silent auction and a splash of birthday-party fun. Following dinner by Wiltshire Pantry, guests will enjoy a fabulous live auction with diverse offerings including spectacular travel packages, unique trees and more.

Twilight in the Garden is Yew Dell's largest and most important fundraiser, bringing in the funds that support ongoing education programs, family events, new plant research and more. Come enjoy a great party and help support what *Horticulture Magazine* recently listed as one of the Top 10 Destination Gardens in the US! Tickets can be purchased on the Yew Dell website or by calling 502-241-4788.

LETTER FROM THE DIRECTOR

Back in 1998 I had the chance to obtain (legally and legitimately I assure you) a few un-rooted cuttings of a rare and wonderful tree from Western China; *Emmenopterys henryi*. Our winters are supposed to be too cold to grow it in Louisville. Cuttings are supposed to be nearly impossible to root. The tree doesn't even have a common name. But being a life-long plant geek, I followed a valuable directive I was taught years ago – *carpe tree-um!* Sieze the Tree . . . My wife was thoroughly unimpressed that I had obtained un-rooted cuttings of a tree I didn't know how to root, that would likely not grow here and about which I knew next to nothing – go figure! Two months later, resulting from mostly pure dumb luck, I had a few successfully rooted cuttings, one of which I planted in my Highlands front yard.

Now my wife is an avid garden/plant appreciator but not anyone you might confuse with an actual gardener - and we tend to look at plants from slightly different angles. While I might ascribe large quantities of "cool plant" points to a plant that takes 30 years to flower, (I think I left that fact-out of our discussions about the prized 6"-tall *Emmenopterys* . . .), she might not be so enthusiastic about my assurance that when it does finally flower, it will be so very cool and all our plant friends will think that we are cool for having it!

Fortunately for me, this story has a happy ending. The now 35'-tall tree has flowered beautifully since its 9th birthday (what . . . don't you all celebrate birthdays for your cool plants?), it fills the neighborhood with a lily-like fragrance for 3-4 weeks and, oops, it now turns out that it will grow 75' tall or more rather than the 30' I expected. But be that as it may, it has turned out to be a truly spectacular tree.

The obvious reader question at this point might be, "aside from this being a moderately amusing little story, why does this matter to me?" Well fast forward the story to 2012 to the point where after several seasons of experimenting at Yew Dell, we've figured out how to root cuttings at fairly high percentages. We have a tray full of rooted cuttings that we'll send out for evaluation. And all that work was done with rudimentary, temporary propagation facilities. Can you imagine what we'll be able to accomplish with our shiny new greenhouse and all the other facilities we're currently building? So stay tuned . . . once we finish construction there will be much, much more to come!

Happy Gardening!
Paul Cappiello
 Executive Director

JOIN US!

Yew Dell membership offers a wealth of benefits including admission all year long, discounts on Yew Dell classes, lectures and workshops, invitation to member-only events and early admission to the annual Plant Sale and Garden Market.

Members also receive discounts at area nurseries and garden centers and coupons and gift certificates for plants and garden supplies—membership pays for itself several times over!

And all of our \$150 and above members will receive a special plant dividend available only at our annual plant sale. For Silver Cloud and above memberships we're even offering guest passes for your friends and family members.

Help us Keep in Touch!

If you have recently changed your email address, mailing address or don't receive any email from us- please let us know!
 Contact Cheryl at CherylL@yewdellgardens.org or call 241-4788.

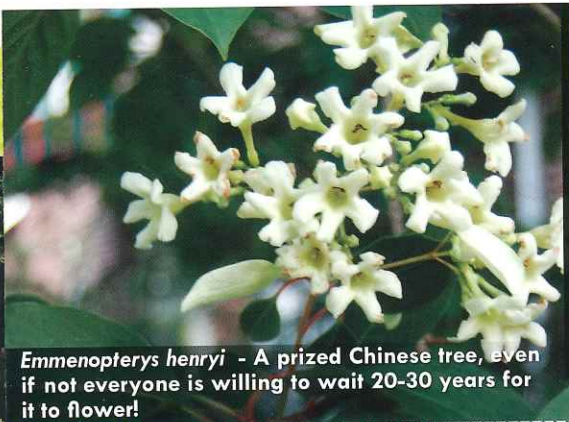

Emmenopterys henryi - A prized Chinese tree, even if not everyone is willing to wait 20-30 years for it to flower!

MEMBERSHIP FORM

LEVELS OF GIVING

- Virginia Bluebells **\$35 (single)**
- Silver Cloud **\$50-\$149 (family)**
- Weeping Katsura **\$150-\$499**
- Golden-Berried Holly **\$500-\$999**
- The Dell Society **\$1000 and above**

Name _____

Address _____

City _____ State _____ Zip _____

Phone (____) _____

Email

VISA Mastercard Discover (CIRCLE ONE) Amount: \$ _____

Card Number: ---

Expiry Date: - (MM-YY) Security Code:

Signature _____

For a list of membership benefits and more information about events and programs, visit our website at www.yewdellgardens.org. Please return this form to:

Yew Dell Botanical Gardens
P.O. Box 1334
Crestwood, KY 40014

2002

February: 33 acre Yew Dell property purchased from the Klein family

December: Paul Cappiello begins as Executive Director

2004

2003

September: Garden Conservancy Stabilization Plan completed

October: First Membership Campaign launched

The High Tunnel is Here!



FoodWorks intern Cathryn Hunt spent the summer researching and creating a plan for Yew Dell's fall/winter vegetable production project.

One of the main projects our FoodWorks intern, Cathryn Hunt, was tasked with when she arrived in the spring was researching and ordering the high tunnel that will be used for our fall and winter vegetable trials. Cathryn didn't have any prior knowledge of high tunnels, what they are and how they work. We gave her a few basic guidelines, 30' x 40' size, roll-up sides for ventilation, had to be mobile, etc. And, by the way, she had to get up to speed, get it purchased and built all within her 9-week internship!

Undaunted, Cathryn got right to work researching high tunnel configurations, seeking advice from experts in the field, collecting cost estimates and, finally, making her recommendation to the Yew Dell staff. A few short weeks later, Yew Dell is now the proud owner of a soon-to-be erected mobile high tunnel that will be central to our fall and winter vegetable evaluation research.

During her short time with us, Cathryn has also put in place a planting plan for our first season of vegetable trials and has started the first transplants that will go in the ground as soon as the high tunnel is up and running. On top of all of this, she has agreed to extend her internship with us a couple of weeks so she can help us through the initial high tunnel planting work.

By the way, Cathryn is a Louisville native and current Middlebury College (VT) student. She interned at Yew Dell through the FoodWorks program, a local program that brings college students to the Louisville area to work in the local food economy.

Thanks Cathryn – you've done an awesome job!

Make Way for the New Greenhouse - Plant Sale!

Our construction is your windfall! We have a nursery full of fabulous plants that we'd normally hold for the spring plant sale but we have to clear out the nursery to make room for upcoming construction work. Join us for ONE DAY ONLY, Thursday, September 13 from 5-8pm. Special pricing and great selections. Regular admission, free as always for members. Check the website news section for a list as we approach the big day!

Out with the old - make way for the new! The old temporary hoop house has to go away to make room for the new greenhouse. That's a great opportunity for you to get your hands on some fantastic plant deals at our one day sale!



Want to post a garden question or tout your own garden?

Hit the Yew Dell Facebook Page. We regularly post photos of the gardens, plant collection trips and even an occasional plant quiz. But you can also post a question, photo of your own garden or join the ongoing conversation. **And to view our images you don't even have to be a Facebook user.** Just go to the Yew Dell homepage (www.yewdellgardens.org) and click on the Facebook box – you won't be able to post but you can see our pictures.

Harry Bounnell
1st Volunteer of the Year

April: Renovation of the Log Cabin,
the Tobacco Barn and the Castle

June: Open to public Saturday
mornings only

2005

Karl Klein
Volunteer of the Year

July: Celebration of 100th Anniversary
of Theodore Klein's birth

September:
First wedding at Yew Dell

HONORARY AND MEMORIAL DONATIONS



Purchase of a memorial/ honorary bench has been and continues to be an excellent way to remember a loved one, mark a special occasion, or honor a valued friend.

Contact a staff member for details.

IN HONOR OF

*In Honor of Barbie Tafel
Garden Club of Louisville*

*In Honor of Nana Lampton
Constellation Energy Foundation*

*In honor of Mary Rounsavall
Ms. Jennie Gerard
Ms. Gayle Dorsey*

*In Honor of Debby Levine
Ms. Laura Lindeman*

*Gifts received between 3/6/12 – 7/24/12.
We apologize for any errors or omissions
in this list of gifts.*

MEMORIAL GIFTS

*In Memory of Marla Barr
Louise Fitzhugh Hickox*

*In Memory of Preston T. Ormsby
Ms. Helen Harting Abell
Ms. Catherine Price Bass
Ms. Sally Campbell
Mr. and Mrs. Joseph Gathright, Jr.
Mr. James B. Leshner
Mr. and Mrs. Samuel G. Miller
The Hon. and Mrs. John Potter
Mr. Jack Roby
Ms. Mary Scoville
Ms. Jacque Parsley and Dr. Robert Sollinger
Dr. and Mrs. William King Stubbs
Mr. and Mrs. Harry Talamini
Ms. Elizabeth Todd
Ms. Mary Webb
Ms. Edith Wells*

*In Memory of Mr. George A. Newman
Mary Broecker*



Yale Bulldog intern Lauren Gardanier (L) and Yew Dell horticulture apprentice Ronnie Kylo in the gardens at Yew Dell.

New Faces Abound at Yew Dell

This summer, we were fortunate to add a few new faces through our internship and apprentice programs.

North Dakota native Ronnie Kylo joined us in May to participate in Yew Dell's apprenticeship program which is designed to bring in recent college graduates to work at Yew Dell for a year-long appointment. Apprentices work with Garden Manager Ann Mattingly, attend industry workshops/events and have a chance to start building their professional network. A recent graduate of South Dakota State University, Ronnie graduated with a landscape architecture degree and a minor in horticulture.

He has a keen interest in botanical garden work with special interest in trees and arborist work. He has already had his hand in about every corner of Yew Dell's activities, including sharing the cabin with Persimmon, Yew Dell's resident cat. Ronnie has worked in the gardens, participated in design sessions for the new greenhouse and is putting his graphics skills to work developing visitor maps for the property. He'll be with us through spring 2013.

Summer intern Lauren Gardanier spent the summer working at Yew Dell as part of the Bulldogs in the Bluegrass program; an effort that brings current Yale University students to Louisville for a wide range of work experiences. A resident of Saratoga, CA, Lauren is returning to Yale this fall as a sophomore and will study business administration and biotechnology with hopes to go into the healthcare field someday (work which we hope to bring her back to the Louisville area)! During her summer at Yew Dell Lauren worked with Communication Coordinator, Jackie Gulbe, on children's programming materials, web marketing projects, Farm to Table event planning and countless other projects that enhance Yew Dell's marketing and promotional efforts.

Cathryn Hunt joined Yew Dell as a summer intern through the FoodWorks internship program – a collaborative program with Middlebury College in Vermont. A profile on Cathryn's work in our vegetable program is included on page 3.

2006

Abi Rennekamp
Volunteer of the Year

April: open hours expanded
to Monday through Sat

September: Adrian Bloom installs
garden below Castle wall

October: Gheens Barn and Peyton
Samuel Head Trust Pavilion Opening

December (05):

350 tree peonies arrive from China

2007

Susan Wilburn
Volunteer of the Year

2012 Late Summer - Fall Programs

See the Yew Dell Website for Complete Descriptions and Program Updates

Hounds on the Grounds! Every Sunday (only)

September & October
Noon-4pm

Seed Saving Techniques Workshop

Saturday, September 15; 12:30-2pm
\$25/\$35 members/non-members

Shrub and Tree Transplanting Workshop

Wednesday, September 26; 6-8pm
\$25/\$35 members/non-members

Twilight in the Garden

Friday, October 5; 6pm
\$200 per person

Dividing Perennials Workshop

Tuesday, October 16; 6-7:30pm
\$25/\$35 members/non-members

Cooking from the Garden – Thanksgiving

Featuring Brown-Forman Executive Chef -
Mark Williams
Sunday, November 11; 1-3pm;
\$30/\$40 members/non-members

Thanksgiving Decorations from the Garden

Saturday, November 17; 10:30-12:30pm
\$35/45 members/non-members

The Yew Dell Express On Track Again!

Friday – November 23; 10-4pm
Saturday - November 24 & December 1, 8,
15; 10-4pm
Sunday - November 25 & December 2, 9,
16; Noon – 4pm

Free with Regular admission

If you missed the train last year – don't miss it this time around! Climb aboard and bring the kids (and grandkids too!) to Yew Dell this holiday season to see The Yew Dell Express – a fabulous snow village and model train display. This magical exhibit was created by master model builder Bob Irmscher with support from some of the most talented model train enthusiasts in the region. In addition to the trains, kids of all ages will enjoy scavenger hunts, and you never know, Santa may pay a visit (check the website for details)! Visitors can also stop in our gift shop featuring unique train themed gifts and holiday items for the garden and nature lover. You might find the perfect holiday gift or two!



Holiday Wreath Workshops

Saturday, December 1
10:30am & 12:30pm

Design and make a unique winter wreath with greenery harvested from Yew Dell with instructor, nurseryman, Jules Klein. Participants will be provided the necessary tools and materials, but participants should bring their own gloves and pruners. Finished wreaths measure 22"-24"
Register early – these classes fill up fast!
\$30 members/\$35 non-members

Williamsburg Wreath Workshop

Saturday, December 1

Check the Yew Dell website for details Garden designer, Tracey Williams will share her tried and true techniques of affixing fruits, vegetables, dried flowers and herbs to create a traditional Williamsburg wreath that will spice up your holiday décor. Participants will be provided the necessary tools and materials, but participants should bring their own gloves and pruners.



Boo Dell

Saturday, October 27
11-3pm

Mr. Magic – 2-3pm

Free admission for all – Parking \$5/vehicle Bring out the kids for this Spook-tacular event! Yew Dell and the Oldham County Library are partnering again to offer this fun-filled, fright-free event. Kids can enjoy trick-or-treating along the trail-o-treats (11-2pm) – dozens of local businesses will entertain with their hallow-weird booths and costumes. Hay rides, a straw maze and a great magic show round out this fun fall day. Bring a pumpkin decorated like a character from your favorite book and enter the Jack-o-Lantern Look-a-Like Contest! This event draws a lot of ghosts & goblins, so come early to get your share of tricks & treats!

2008

Carolynne Breedon
Volunteer of the Year

April:
Open 7 day a week

May:
1st Garden Sculpture Show

August:
Pond Reconstruction

April:
1st Hellebore Day

October:
1st Boo-Dell

Gardens Pests Abound in 2012 – and here's a bit of what we've learned!



Rose Rosette

If you grow roses in your garden, chances are you've encountered this beast. Caused by a virus and spread by all the piercing/sucking insects (leaf hoppers, thrips, aphids etc.), rose rosette has hit the area with devastating results. Infected plants produce a combination of stunted and densely branched growth as well as uber-vigorous red-stemmed shoots crowded with tiny thorns. The biggest problem is that there seems to be no reasonable control for this pest. Once infected, plants may show no symptoms for up to three years, making it likely that unsterilized pruners will spread the pathogen from infected to healthy plants (be sure to sterilize your pruners between plants – 50% rubbing alcohol does a good job). In addition, the preferred host rose is *Rosa multiflora*, the ubiquitous invasive multiflora rose of most Kentucky fence rows. Our recommendation . . . if your roses look healthy, spray as much as you are comfortable with to control insect vectors, regularly sterilize your pruning equipment, quickly remove plants that show visible symptoms (double bag and throw away; don't compost infected plants) and . . . enjoy them while they last. Sorry. We wish we had better news!



Blister Beetles

Most gardeners have never heard of these little pests but they can do a world of damage in short order. They look like fire flies with extra yellow striping on their upper wings. For two years, this insect has completely stripped all the leaves off our fall-blooming Japanese anemones (*Anemone xhybrida*) and each time, they've done their worst in the span of just a few days. As a result you have to either scout plants on a daily basis to time your spraying or you have to begin your spray schedule in early June and continue through the middle of August. We've tried neem oil and other organic controls with no luck. A more aggressive insecticide may be necessary to achieve good control. The good news is, if you can put up with bare stems through the midsummer, plants tend to send out new growth from the base and make a somewhat reduced fall flower show.



Cabbage Looper

The bane of all vegetable gardeners . . . this is one of the beasts that eats big holes in your cabbage, kale and all their relatives. The culprit is a 1"-long green caterpillar and the adult is a camo-like brown moth. This year, we've had great luck controlling the looper with a combination of scouting and organic spray. Starting as soon as transplants are set out, look on the lower leaf surface for single translucent white eggs about 1/3" long. Simply rub them off on a regular (daily) basis. Adding Bt sprays (upper and lower leaf surface) at 7-10 day intervals has worked wonders. Bt (*Bacillus thuringiensis*) is an organic material that works on most caterpillars and is quite safe to use in the garden.

2009

Stan Hankins
Volunteer of the Year

April:
New vegetable garden planted

August:
1st Hummingbird Festival

October:
Plant collecting trip to Japan

2010

Debby Levine
Volunteer of the Year

April: AIA-Award-winning
Visitor Center Opens

MORE WEEDS THAN
GRASS?



Limbwalker

IS NOW OFFERING

**LAWN
RENOVATION**

LAWN RENOVATION IS THE BEST WAY TO DELIVER A PREMIUM LAWN IN THE SHORTEST PERIOD OF TIME. IT'S ALSO GREAT FOR LAWNS OVERRUN BY WEEDY GRASS SPECIES (LIKE BERMUDA GRASS). THIS SERVICE INCLUDES FOUR VISITS DESIGNED TO KILL OFF YOUR OLD LAWN AND REPLACE IT WITH A BRAND NEW ONE.

502.634.0400

www.limbwalkertree.com

nature

BY DESIGN



Suzette White

Design, Landscape & Maintenance

502-222-4501

www.suzettesgazette.com



**Beechwood
Trees & Gardens**

Since 1988

bwtrees.com

Office 502-241-0471 ☎ Cell 502-296-3825 ☎ pclinton@bwtrees.com

Paul Clinton

ISA Board Certified Master Arborist
Kentucky Certified Nurseryman



**GREENHAVEN
TREE CARE
INC.**

Call today for a quote!

- Pruning
- Tree & Stump Removal
- Consulting
- Cabling
- Fertilization

Office: (502) 244-8770 Fax: (502) 244-8770

www.GreenhavenTreeCare.com

1901 Williamson Court, Louisville, Kentucky 40233

STIFEL NICOLAUS

Investment Services Since 1890

David S. Whitty

Vice President/Investments

(502) 420-3247

4969 U.S. Highway 42 • Suite 1000
Louisville, Kentucky 40222

Stifel, Nicolaus & Company, Incorporated | Member SIPC and NYSE



**Eco-Tech
CONSULTANTS**

Ecological habitat restoration and maintenance
on private lands, parks, and natural areas.

Let us bring your vision to life -
call for free consultation.

Lee Droppelman, President

(502) 259-0454 ldroppelman@ecotechinc.com

11321 Decimal Drive, Louisville, KY 40299
www.ecotechinc.com

June:

1st International Garden Tour; England

2011

Wes Krupiczewicz
Volunteer of the Year

April: Children in the Dell
classes start

June:
1st Farm to Table Dinner

October: Yew Dell on the National Register of
Historic Places, 2nd International Garden Tour; Italy

YEW DELL BOTANICAL GARDENS

6220 Old LaGrange Road • Crestwood • Kentucky • 40014 • www.yewdellgardens.org

NON PROFIT ORG
U.S. POSTAGE
PAID
Louisville, Ky.
PERMIT #879



Yew Dell Botanical Gardens is a partnership project of the Garden Conservancy, a national, non-profit organization founded to help preserve America's exceptional gardens.

THE CASTLE CHRONICLES

Summer 2012



OPEN HOURS

LATE DECEMBER THROUGH MARCH:

Monday through Friday: 10am to 4pm

APRIL THROUGH MID-DECEMBER:

Monday through Saturday: 10am to 4pm

Sunday: noon to 4pm

Don't forget to bring your membership card to get 10% off at the garden shop!



'LIKE' US ON FACEBOOK

SPECIAL THANKS TO:

Publisher's Printing and United Mail, Inc.



YEW DELL BOTANICAL GARDENS