

# The Castle Chronicles

FALL 2010



*Franklinia alatamaha*

## TWILIGHT IN THE GARDEN 2010

Before you know it, all this dreadful heat and humidity will finally yield to fall. And at Yew Dell, that means we are preparing for our biggest event of the year, **Twilight in the Garden**. On **Saturday, October 9th**, we invite you to join us in the gardens for a gourmet dinner and cocktails, fabulous silent and live auctions and a gathering of new and old friends. This year, Yew Dell will bring you a fantastic evening under the stars with a few new twists!

Our much-anticipated auctions will be filled with great items and packages, vacation homes and some of the best plant items anywhere. After last year's feeding frenzy over the orange-barked Japanese maple, we've done it again. This year will feature the only truly columnar Japanese maple ever offered. *Acer palmatum* 'Tsukasa Silhouette' is unavailable on the market today. Our own Paul Cappiello photographed this selection at Mr. Tanaka Tsukasa's nursery outside Tokyo during his October 2009 plant collecting trip. And we've managed to secure a 7'-tall specimen for your bidding pleasure.



*Acer palmatum* 'Tsukasa Silhouette'

As Yew Dell's most important fundraiser, *Twilight* supports garden research and educational programming throughout the year. So join us for *Twilight* to help support Yew Dell's contributions to your life and landscape. Check our website beginning in September for a listing of more fabulous auction items. Tickets and full table reservations are available. **Call 502.241.4788 to reserve your spot today!**



## YEW DELL HEADS TO ITALY!

If you went on the southern England trip last spring, you know how much fun we had. If you weren't part of the group, you've probably heard rave reviews of the excursion. Either way, here's your next chance to spend 10 days touring some of the best garden country in the world. The lake district of northern Italy combines a unique moderate climate and varied (and gorgeous!) topography to provide some of the best garden-growing anywhere. Stunning views of Lake Maggiore, Lake Cuomo and Bellagio will provide the perfect setting for garden and palace touring: Villa Taranto, the Palace of Isola Bella, and way too much to list here.

Tentative dates for the trip are June 6-17, 2011. For complete itinerary/cost information, and to reserve your spot, **call Yew Dell at 502-241-4788**. Call soon. With only 20 slots, this trip is likely to fill quickly!

## Hydrangea family members in Yew Dell's collection

Members of the family *Hydrangeaceae* cover tropical, subtropical and temperate regions of North and South America, Europe and Asia.

### *Hydrangeaceae*

Genera .....6  
(*Decumaria*, *Deinathe*, *Hydrangea*, *Kirengeshoma*, *Philadelphus*, *Schizophragma*)

Species .....13

Varieties .....54

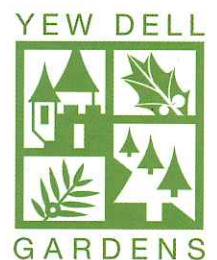

# Director's Letter

I am constantly intrigued by counter-intuitive happenings in the world around us. Consider the science of probability and statistics. How unlikely does it seem that in any random group of 30 people, it is more likely than not that two will share a common birthday? Or flip a coin 30 times and keep track of heads and tails. To me, it seems unlikely that you would find a sequence of 5 consecutive heads or 5 tails. But, on average, it's more likely than not that a run of 5 should occur. Common but intuitively unlikely occurrences seem to be the events or accomplishments that make us do a double take.

Now consider another counter-intuitive series of events. How about an organization with a little plot of land, a bunch of overgrown gardens, aging homemade buildings and no money in the bank? How likely would it be that that little group, with its suspect starting materials, being forced to face the most significant financial crisis in the last 60 years, would today be accelerating through a growing national and international reputation for innovation and top-notch programs? Doesn't seem all that likely—on the surface that is.



*Hosta 'Sagae'*

At the late-May opening of our 3rd Annual Garden Sculpture show, we opened Yew Dell's new Visitor Center and Garden Shop. The first meeting with architects occurring in mid January, how likely was it to design, build, stock, staff and open a spectacular new facility in just over 4 months? Seems unlikely, on the surface that is.

Yew Dell seems to have developed a knack for turning heads. Our board, staff and volunteers have consistently shattered standards, outperformed expectations and, quite literally broken new ground. And this fall we'll continue that work. From programs for kids (Boo Dell!) to our outstanding concert series, the party of the year "Twilight in the Garden" and even a fabulous new website to be launched later this fall, there will be plenty to see and

follow on the grounds and online. From humble beginnings, how unlikely would it seem to be at this point just under 10 years later...quite unlikely...but only on the surface.

Happy Gardening!

*Paul Cappiello, PhD*  
Executive Director



*Cercidiphyllum japonicum*

## LEAVING A LEGACY

As Yew Dell continues to grow, we invite you to join us on our journey and ask you to consider a planned gift for Yew Dell; a bequest, beneficiary assignment, charitable remainder trust or any other vehicle you determine works best for you. If you already have plans for a bequest or other planned gift, please let us know, as we would like to honor your support by making you a member of our Legacy Society. If you are interested in making a gift, but need more information, please call **Leah Whitmer at 502.241.4788**. We would be delighted to work with you to create a plan that will meet your goals.

## PLAN FOR A BEAUTIFUL 2011; PLANT BULBS THIS FALL!

Given the heat of this past season, even the most devoted gardener can hardly be blamed for threatening to throw in the towel this fall. But this is the time to be looking toward next season—toward those first blooms of the 2011 garden. And there is no better way to usher in a new season than with the insuppressible charm of the minor bulbs.

The minor bulbs offer an early spring shot of welcome relief after the grey of a Kentucky winter. Starting off the bloom season as early as late January, they lead the way into the heart of spring.

The up sides of minors are many. They are inexpensive and easy to plant. Most remain unmolested by rodents or deer and many naturalize well (if you avoid the pre-emergent herbicides) in lawns and beds. Just give them full sun or part shade and minimal fertilizer. We recommend you buy and plant them by the bagfull!

Here are a few of our favorites:



*Eranthis hyemalis (winter aconite)*

*Eranthis hyemalis* (winter aconite) is one of the best naturalizers for shady areas. The brilliant, sulfur-yellow flowers are set off nicely by the glossy green leaves through February and March. Members of the *Ranunculaceae* (buttercup family) these 3-4"-tall harbingers of spring can easily be dug, potted and forced indoors for an even earlier shot of color.



*Galanthus nivalis (snowdrops)*

*Galanthus nivalis* (snowdrops) are dainty white gems that usually emerge in mid to late February. The 6"-tall members of the *Liliaceae* (lily family) offer pendulous white flowers, sometimes dotted with green. They are quite inexpensive to buy, but those with an appetite for the unusual can find doubles, ruffled and variegated forms and more. There are more than 100 named forms on the collector's market.



*Scilla siberica (Siberian squill)*

*Scilla siberica* (Siberian squill) is one of the very best of the blues in the plant world. Growing to 4-6" tall, this member of the *Hyacinthaceae* family is excellent for naturalizing in lawns and tucked into rock gardens. They bloom in March, after the *Galanthus* and *Eranthis* have done their thing. There are pale blue forms, white, and even pink forms. And for the mildly adventurous gardener, there are many other species to be tried.



*Puschkinia scilloides (striped squill)*

*Puschkinia scilloides* (striped squill) is closely related to and often confused with *Scilla*. Both minors are members of the *Hyacinthaceae* family, are blueish in flower color and flower at about the same time. However

*Puschkinia* are typically paler blue with a distinct white center and a deeper colored stripe on the outside of each petal. The flowers are generally upward or outward facing rather than the typically pendant *Scilla*. *Puschkinia* is excellent in small containers and dotted through shrub beds.



*Leucojum vernum (snowflake)*

*Leucojum vernum* (snowflake) is the latest of the bunch to bloom, offering pendulous cups of green-dotted white atop 8" stems in April. While too tall to naturalize in the lawn, snowflakes are excellent for spotting through perennial and shrub beds. They bloom much longer than most of their cousins, with single plants in bloom lasting three

weeks or more. For the giant among minors, *Leucojum aestivum* (giant snowflake) reaches lofty heights of 12" and blooms a tad later than *L. vernum*.

And while it is not strictly one of the minor bulbs, we offer one small and fabulous tulip—for all you out there that just have to grow one...

*Tulipa turkistanica* is an excellent species tulip that not only grows in Kentucky; it thrives and multiplies! Plant these in a sunny to partly shady site on dry summer soil and simply enjoy. They aren't deer proof, and the rodents will occasionally relocate a few for you, but if you can keep the deer off them, this dainty species will reward with years of mid-spring color. Who says we can't grow good tulips in Kentucky?!

While there are many sources out there for minor bulbs, we are happy to suggest our friends at **Brent and Becky's Bulbs**. They offer excellent quality, an outstanding selection, and generously offer us a donation of 25% of the value of your bulb order! Simply go to [www.bloominbucks.com](http://www.bloominbucks.com) and select Yew Dell Gardens as your institution of choice. The site will lead you directly to Brent and Becky's site to place your order. It's as simple as that. Buy great bulbs and support Yew Dell at the same time!

# Upcoming Garden Education & Events



Whiskey Bent Valley Boys

## BROWN-FORMAN THIRD THURSDAY CONCERT SERIES

**\$12/members; \$15/non-members; All shows begin at 7pm**  
The Second Annual Third Thursday Concert Series in the Gheens Barn is winding down. You only have a few more chances to see one of the best summer music series in the area. Be sure to reserve your spot now, seats are going quickly!

9/16—Whiskey Bent Valley Boys CD Release Party!

10/21—Keltricity

11/18—Harry Pickens Trio



**BROWN-FORMAN**

## TWILIGHT IN THE GARDEN

**Saturday, October 9; 6:30pm**  
**\$175/person; table of ten, \$1,750**

Join us for Yew Dell's annual event featuring outstanding live and silent auctions, dinner and Brown-Forman cocktails among some of the best gardens in the region. Tickets and table reservations are available by calling 502.241.4788.

## IN THE GARDEN OF LIFE WITH HARRY PICKENS

**October 10; 2:00 - 5:00pm**  
**\$20/members \$25/non-members**

How are you nurturing the garden of your life? Join us for an afternoon of musical and metaphorical explorations with Harry Pickens. We will tap into the power of music and nature to help us rest, renew and restore mind, body, and spirit. Space is limited, so reserve your spot online now.

## FABULOUS FALL FOLIAGE AND FRUIT: A PLANT WALK WITH THE DIRECTOR

**Tuesday, October 19, 6-7:30pm**  
**\$10 Members/\$15 non-members**

Yew Dell's plant collections will be at their autumn peak so this will be the perfect time to pick out some new selections for your own garden. Beyond the fall foliage display, we'll cover fruiting shrubs for winter display, cutting for decoration and for attracting and feeding wildlife.

## BOO DELL

**Saturday, October 30; 11:30 - 3pm; Free Admission;**  
**Parking \$5/car**

Calling all ghouls and goblins! Yew Dell and the Oldham County Library have teamed up once again to offer fright-free trick-or-treating 'til 2pm, a jack-o-lantern contest and Mr. Magic (2pm). Come in your Halloween best and bring the kids! Food and refreshments will be available.



Boo Dell

## YEW DELL GARDENS PRESENTS THE SLOW FOOD SCHOOL OF TRADITIONAL COOKING

**Wednesday, November 10; \$20/members (Slow Food or Yew Dell members), \$25/non-members**

Our first class in this series of traditional cooking from around the world will focus on our own regional cuisine. Southern Appalachian Food and Food lore will introduce you to foods that originated in this region, with an emphasis on seasonal ingredients and traditional farming methods. Come learn how to prepare Beaten Biscuits with Sorghum, Burgoo, Osgood Pie and Chow Chow, among others, in this 2 hour interactive class led by Slow Food USA Southern Regional Governor Mark Williams. You'll get to sample the food and get a better understanding of our own Kentucky food heritage.

## WREATH AND TOPIARY WORKSHOP

**Saturday, December 4; \$30/members \$35/non-members; Wreath Workshops 10am - 12pm & 2pm - 4pm; Topiary/Centerpiece workshop from 12pm - 2pm. Price is per workshop and covers one piece. Additional fee of \$15/piece applies.**

What could be better than a wreath or centerpiece made from fresh greenery made from Yew Dell's own trees? Jules Klein and Garden Manager, Jo Anne Fischer will lead workshops to help you celebrate the holidays in style.

To register, visit:  
[www.yewdellgardens.org](http://www.yewdellgardens.org)  
or call 241.4788

Advance registration required for all charge events

## MEMORIAL/HONORARY DONATIONS

March 1, 2010 – July 30, 2010

### IN HONOR OF:

**Paul Cappiello & Karla Drover**

*Mr. & Mrs. Dale Woodall*

**Carolyne Breeden**

*Ms. Deborah Keithley*

**Robert & Mary Rounsavall**

*Mr. & Mrs. Finbar Dempsey*

### IN MEMORY OF:

**Ella Barker**

*Mr. & Mrs. Robert W. Rounsavall, III*

**Ruth Griffin**

*Mr. & Mrs. Jerry Schmitt*

**Noreen Rucker**

*Ms. Claudia Archimede.*

*Mrs. Elsie Atherton*

*Mr. and Mrs. Bill Blodgett*

*Dr. and Mrs. William Blodgett, Jr.*

*Mr. and Mrs. Allen M. Bond, III*

*Mr. and Mrs. Morton Boyd*

*Mr. and Mrs. Eli H. Brown, IV*

*Mr. William H. Camp*

*Mr. and Mrs. Sam Conner*

*Ms. Chenault M. Conway*

*Mr. and Mrs. John Cooke*

*Mr. and Mrs. S. Gordon Dabney, Sr.*

*Mr. and Mrs. William Davis*

*Mr. and Mrs. L. D. Deters, Jr.*

*Ms. Mildred Kemp Dockstader*

*Ms. Phyllis Florman*

*Mr. and Mrs. Thomas W. Gaines, Jr.*

*Mr. and Mrs. Barry Garbino*

*Mr. and Mrs. Peter Graves*

*Mr. and Mrs. Orn Gudmundsson*

*Ms. Alice Hartley*

*Ms. Louise Fitzhugh Hickox*

*Mr. Joel Jansing*

*Dr. and Mrs. Lawrence Jelsma*

*Ms. Karen Kremer*

*Ms. Nana Lampton*

*Dr. and Mrs. Gary Lavin*

*Mr. and Mrs. Hunter Louis*

*Mr. and Mrs. Fairleigh Lussky*

*Mr. and Mrs. Lloyd Markland*

*Mr. and Mrs. Robert Martin*

*Mr. and Mrs. Grier Martin*

*Ms. Arlyn Metcalfe*

*Ms. Eleanor Miller*



*Dalechampia discolorifolia (bowtie vine)*

*Mrs. Gordon Ragan*

*Mr. and Mrs. Ken Reutlinger, Jr.*

*Mr. and Mrs. Robert W. Rounsavall, III*

*Ms. Nicole Rucker*

*Mr. Patrick Rucker*

*Mr. and Mrs. Don Rucker*

*Mr. and Mrs. Corwin Short*

*Mr. J. Michael Skelton*

*Mr. and Mrs. Llewellyn Spears, III*

*Sutherland Foundation, Inc.*

*Mr. and Mrs. Hugh Walker*

## MEMBERSHIP

Yes, I want to show my support of Yew Dell Gardens by becoming a member today.

\_\_\_ Virginia Bluebells (\$35/single membership)

\_\_\_ Silver Cloud (\$50/family membership)

\_\_\_ Weeping Katsura (\$150 - \$499)

\_\_\_ Golden-Berried Holly (\$500 - \$999)

\_\_\_ The Dell Society (\$1,000 & above)

\_\_\_ Other Donation

\_\_\_ Contact me about volunteer opportunities at Yew Dell

Membership purchase also available on the Yew Dell Gardens website ([www.yewdellgardens.org](http://www.yewdellgardens.org))

Total Contribution \$ \_\_\_\_\_

Name \_\_\_\_\_ Phone \_\_\_\_\_

Address \_\_\_\_\_ City \_\_\_\_\_

State \_\_\_\_\_ Zip \_\_\_\_\_ Email \_\_\_\_\_

Method of Payment: \_\_\_ Personal Check \_\_\_ MasterCard \_\_\_ Visa Exp. Date \_\_\_\_\_

Card Number \_\_\_\_\_ Signature \_\_\_\_\_

PLEASE MAIL YOUR  
MEMBERSHIP TO:  
YEW DELL GARDENS  
P.O. BOX 1334  
CRESTWOOD, KY 40014

Yew Dell membership offers a wealth of benefits including admission all year long, discounts on Yew Dell classes, lectures and workshops, invitation to member-only events and early admission to the annual Plant Sale and Garden Market. Members also receive discounts at area nurseries and garden centers and coupons for plants and garden supplies—membership pays for itself several times over! We also offer all our \$150 and up members a special plant dividend available only at our annual plant sale. We're even offering guest passes for your friends and family members. Check the website for complete details.

# YEW DELL HAPPENINGS

## MEET THE INTERNS

If you have stopped by Yew Dell recently, you may have noticed our three summer interns roaming the grounds: Sarah Baltzley, a Masters candidate in plant and soil science at the University of Kentucky, Evan Hart, a sophomore in environmental science at Northern Kentucky University, and Annie Wang, a sophomore in political science at Yale University. Sarah and Evan have been watering, weeding, potting and propagating under the direction of Garden Manager Jo Anne Fischer while Annie has played it cool working in the air-conditioned offices.

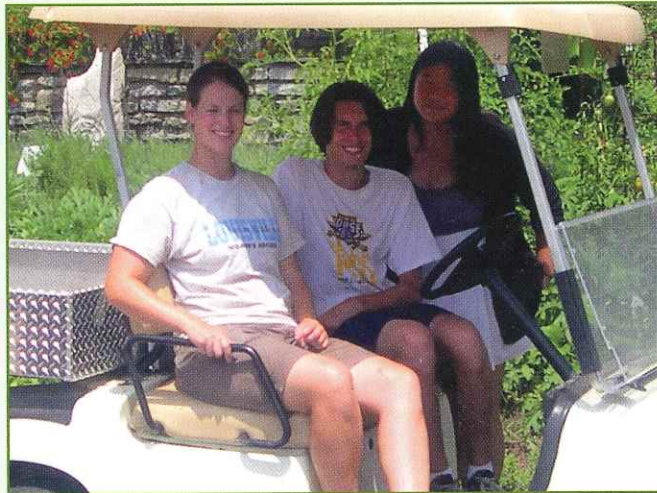

*Yew Dell's interns enjoying a work vehicle generously provided by a grant from the The Honorable Order of Kentucky Colonels.*

So what do our interns do? A typical day for Sarah or Evan might be described as watering, watering, projects for Jo Anne and more watering. While you might believe watering is easy, Sarah begs to differ: the most surprising thing she's learned this summer is "how easy it is to water incorrectly." Still, Sarah and Evan have enjoyed working at Yew Dell, and have even worked on marking off a

mile of hiking trails through our woodland and pond areas. As Evan says with a laugh, "this way, we can send people down and not worry about them getting lost."

While Sarah and Evan are Louisville natives, Annie hails from Atlanta, Georgia and is here as part of the Bulldogs in the Bluegrass, a program organized by local Yale alumni that sponsors events and outings to introduce students to the Greater Louisville area. Over the past 12 years, about 50 former Bulldogs have moved to the Louisville area after graduation. At Yew Dell, Annie

has worked on a variety of projects, from organizing photos for the new website to designing a brochure on the history of Yew Dell. "What I love about Yew Dell," she says, "is how close everyone is. I can always talk to the staff about any questions, and I never feel uncomfortable asking Paul about our latest research."

We wish all the interns the best of luck in the coming school year!



*Yew Dell recently received funding from Oldham County Storm Water Management District (OCSWMD) to design a demonstration rain garden that will be used for educational purposes. From left to right: Paul Cappiello, OCSWMD Board Members Steve Cummings, Art Henson, and Board Chairman Kevin Eldridge.*



*Welcome to our newest staff members, Patricia, Peggy and Cheryl! Along with our own Bonnie Heaton, they've been staffing the new visitor center & garden shop. Come do some holiday shopping and meet our growing team.*

**WE'RE BIG ON NURTURING.**

With our roots strongly in Kentucky, Mountjoy Chilton Medley LLP helps businesses and individuals grow the seeds of their goals well beyond sprout. Let us tend to the growth plan you have in mind.

502.749.1900  
www.mcmcpa.com

**Mountjoy  
Chilton  
Medley**

LOUISVILLE | LEXINGTON | COVINGTON | FRANKFORT | BOWLING GREEN

An Independent Member of Baker Tilly International

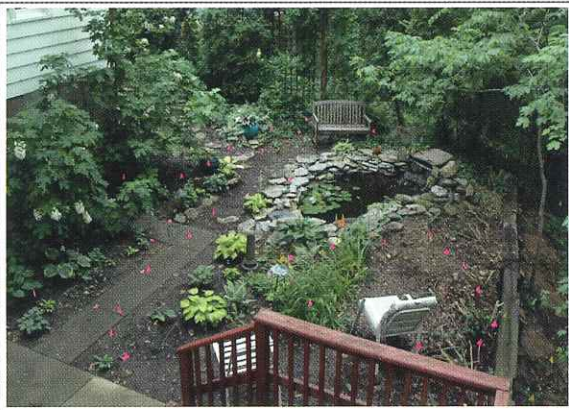

*Before...*

Beechwood Trees and Gardens offers full landscape design services including:

- Planting plans
- Fountains, ponds, and water features
- Patios, walkways, stairs, and retaining walls



**Beechwood  
Trees & Gardens**

Crestwood, KY 502-241-0471

*Turning landscape dreams to reality since 1988*

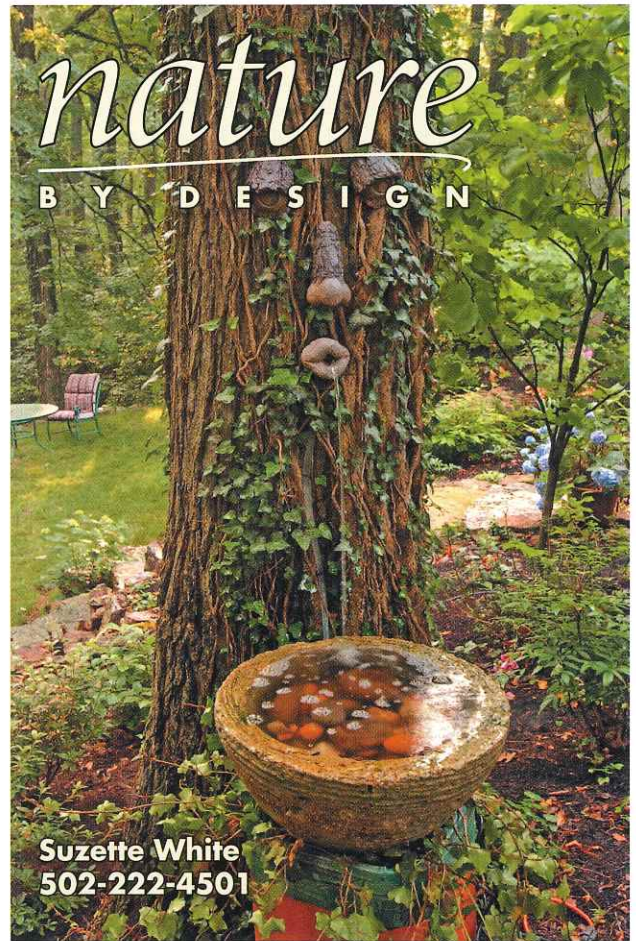

**Suzette White  
502-222-4501**

*Turning landscape dreams to reality since 1988*



**Beechwood  
Trees & Gardens**

Crestwood, KY 502-241-0471

Beechwood Trees and Gardens offers full landscape installation and maintenance services including:

- Planting trees, shrubs, and groundcover
- Pruning, mulching, and fertilization
- Installing walls, walks, and patios
- Tree removal, stump removal and grinding

*After...*



**GREENHAVEN  
TREE CARE  
INC.**

- Pruning
- Tree & Stump Removal
- Consulting
- Cabling
- Fertilization

Office (502) 244-8770  
FAX 244-8771

**1901 Williamson Court  
Louisville, Kentucky 40223**



## GET AN EARLY START ON YOUR HOLIDAY SHOPPING!

Don't wait, Start your holiday shopping now. Yew Dell's new visitor center and garden shop carries locally made art, the best garden tools, books and unique gifts for kids. Don't forget that members always get a 10% discount!

*Hand-turned wooden ikebana vase available at Yew Dell's Garden Shop*



Yew Dell Gardens is a partnership project of the Garden Conservancy, a national, non-profit organization founded to help preserve America's exceptional gardens.

### Staff

DR. PAUL CAPIELLO

Executive Director

KARLA DROVER

Assistant Director

LEAH WHITMER

Director, Marketing & Development

BONNIE HEATON

Volunteer Coordinator

JO ANNE FISCHER

Gardens Manager

DON HIGHTCHEW

Buildings & Grounds Manager

IRIS GOODE

Development Associate

CHERYL LEIFER

PATRICIA GATTIS

PEGGY WINKLER

Visitor Center Associates

NON PROFIT ORG  
U.S. POSTAGE  
PAID  
Louisville, Ky.  
PERMIT #879

### The Castle Chronicles

**YEW DELL, INC.**

6220 Old LaGrange Road

Crestwood, KY 40014

(502) 241-4788

### OPEN HOURS

April through November:

Monday - Saturday 10 a.m. - 4 p.m.

Sunday noon - 4 p.m.

December through March:

Monday - Friday 10 a.m. - 4 p.m.

Special thanks to:

Publisher's Printing Co.  
*printing*

United Mail, Inc.  
*distribution*

**David S. Whitty**

*Vice President/Investments*

**(502) 420-3247**

4969 U.S. Highway 42 • Suite 1000

Louisville, Kentucky 40222

**STIFEL NICOLAUS**

*Investment Services Since 1890*

Stifel, Nicolaus & Company, Incorporated  
Member SIPC and NYSE



## Limbwalker

### Tree Service, Inc.

Fully Insured • Locally Owned  
Certified Arborists







The first and only  
TCIA accredited tree service  
in Kentucky.



- Removals • Pruning • Cabling / Bracing •
- Plant Health Care • Soil Conditioning • Root Pruning •
- Tree Injections • Emerald Ash Borer Treatments •

[www.limbwalkertree.com](http://www.limbwalkertree.com)

(502) 634-0400

Kentucky tree climbing champions  
2002, 2003, 2005, 2006, 2007, 2008, 2009